

**THE TOOL FOR
ALL TRADES**

multiscribe

marking a new revolution in tooling

The new Multiscribe marks a new era in professional and domestic work tools.

Its profile matching functions can be used to transfer contours from one shape to another and mark onto various materials.

Plus, its many extra features make all types of jobs around the home quick, easy and hassle free!

For more information about how the Multiscribe works, click on a thumbnail:



For more information on the multiscribe please telephone:

BH  **Blundell Harling**
MANUFACTURING SOLUTIONS
01305 206 000

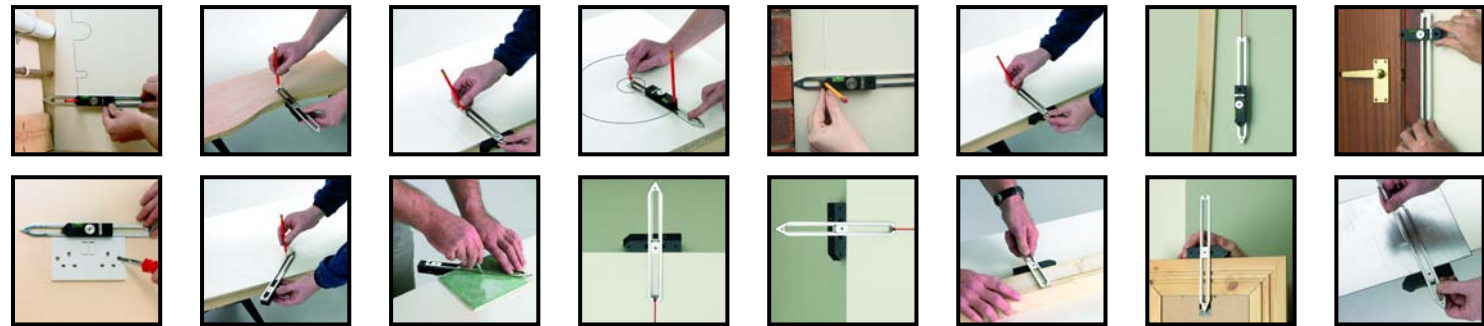
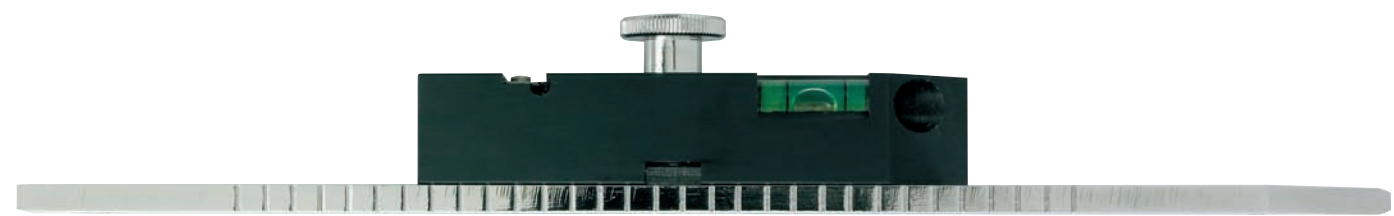

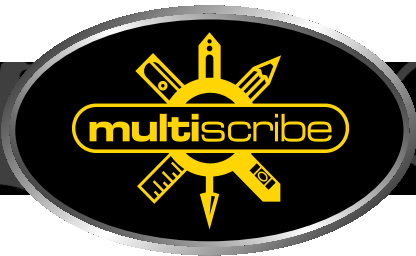

THE TOOL FOR ALL TRADES

PROFILING SCRIBE

To copy and reproduce exactly an irregular shape

[Click here to return to start](#)

(To exit press ESCAPE)

For more information on the multiscribe please telephone:

BH  **Blundell Harling**
MANUFACTURING SOLUTIONS

01305 206 000

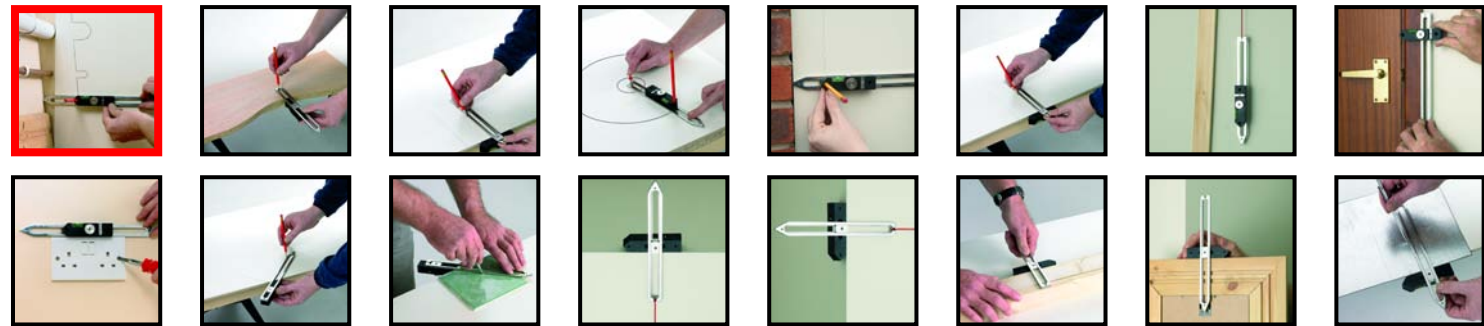

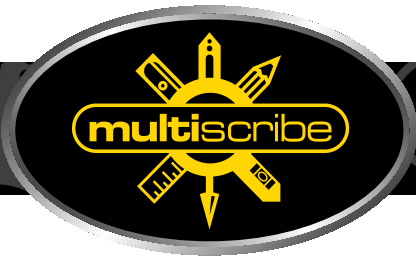

**THE TOOL FOR
ALL TRADES**

CONVEX SCRIBE

To copy and reproduce
exactly a convex line
or shape

[Click here to return to start](#)

(To exit press ESCAPE)

For more information on the
multiscribe please telephone:



01305 206 000

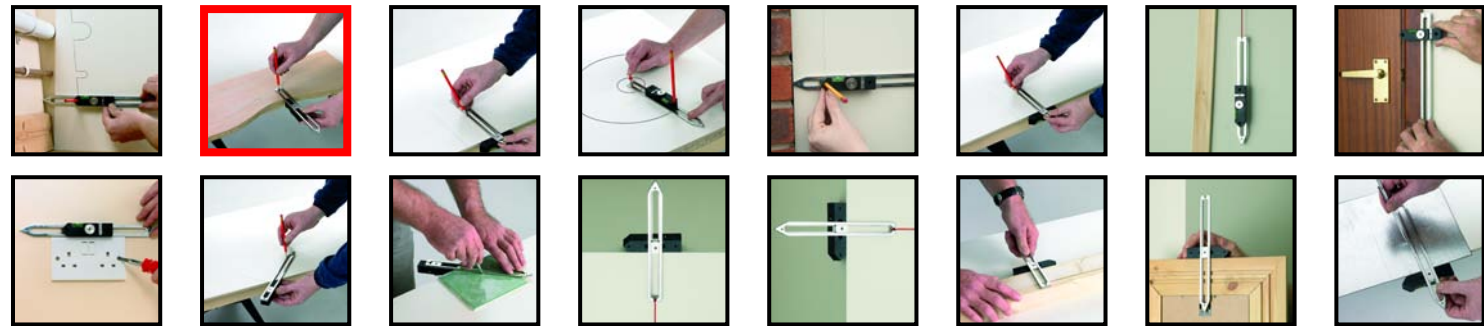

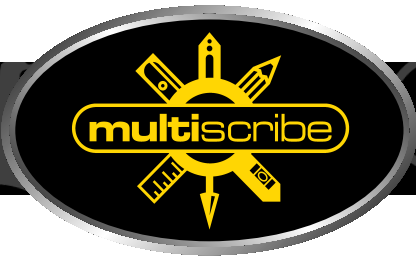

**THE TOOL FOR
ALL TRADES**

PARALLEL SCRIBE

The drawing of an
equidistant line parallel
to a chosen edge

[Click here to return to start](#)

(To exit press ESCAPE)

For more information on the
multiscribe please telephone:



01305 206 000

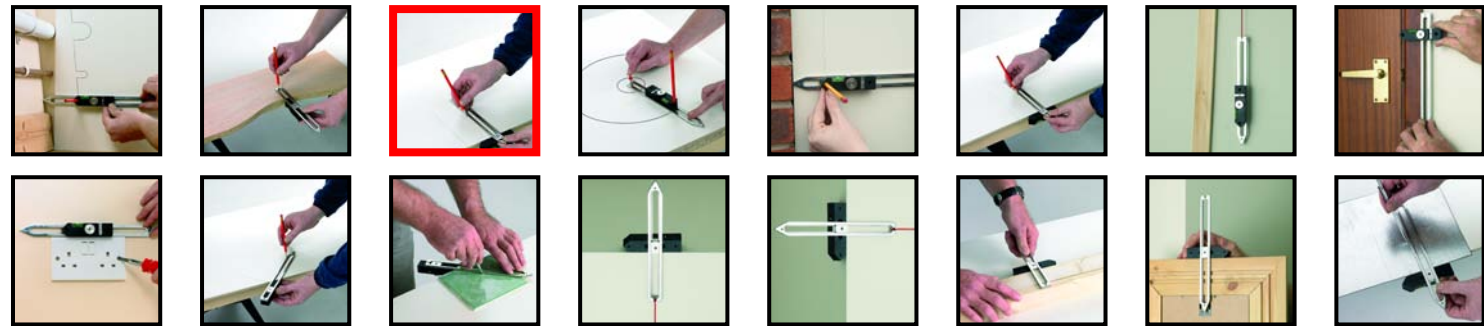
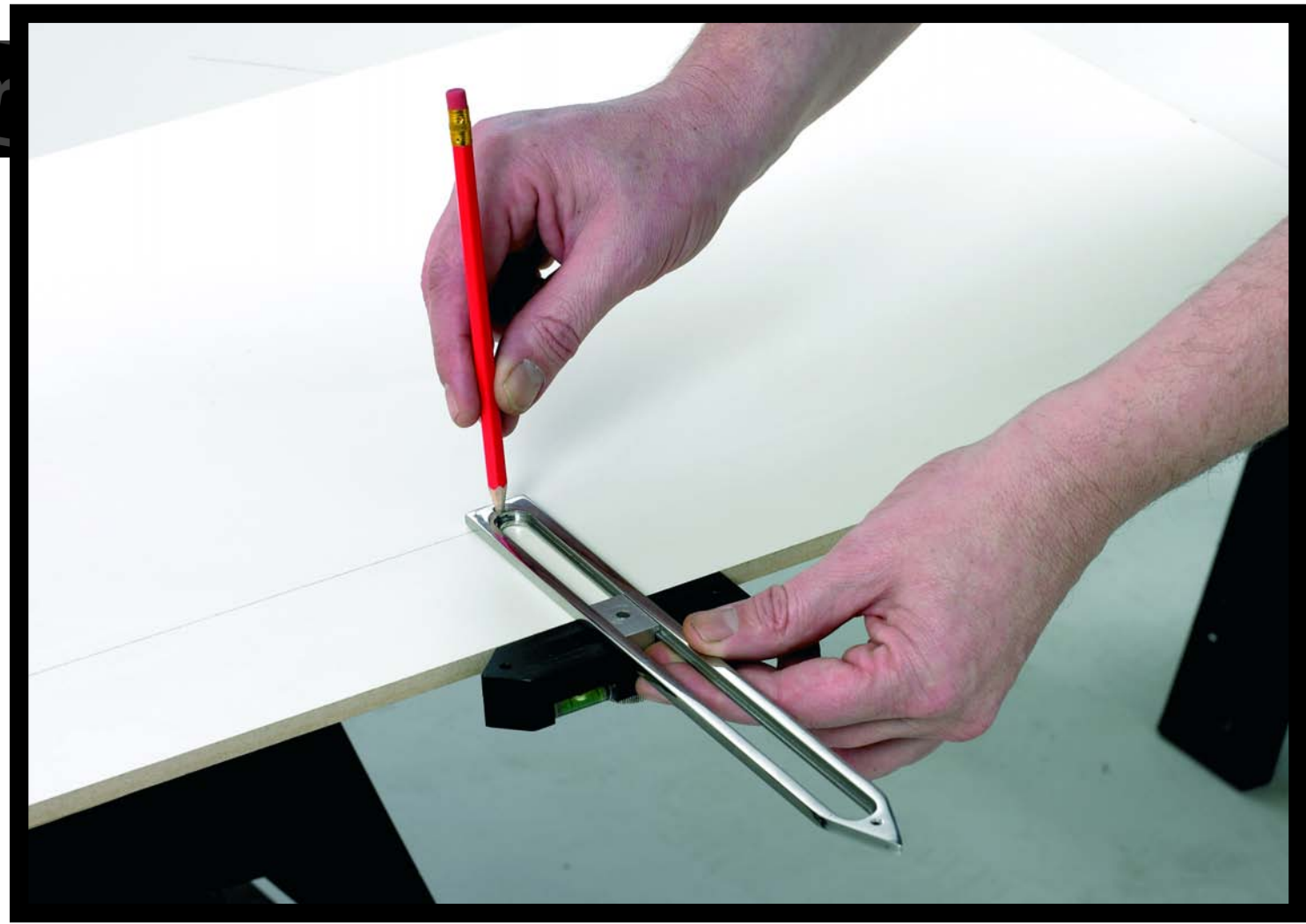

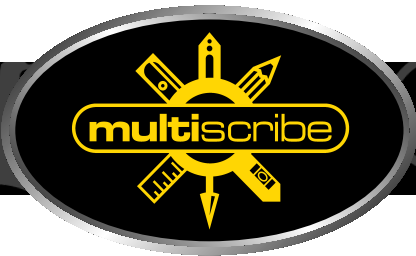

THE TOOL FOR ALL TRADES

COMPASS

The drawing of circles with various diameters

[Click here to return to start](#)

(To exit press ESCAPE)

For more information on the multiscribe please telephone:



01305 206 000

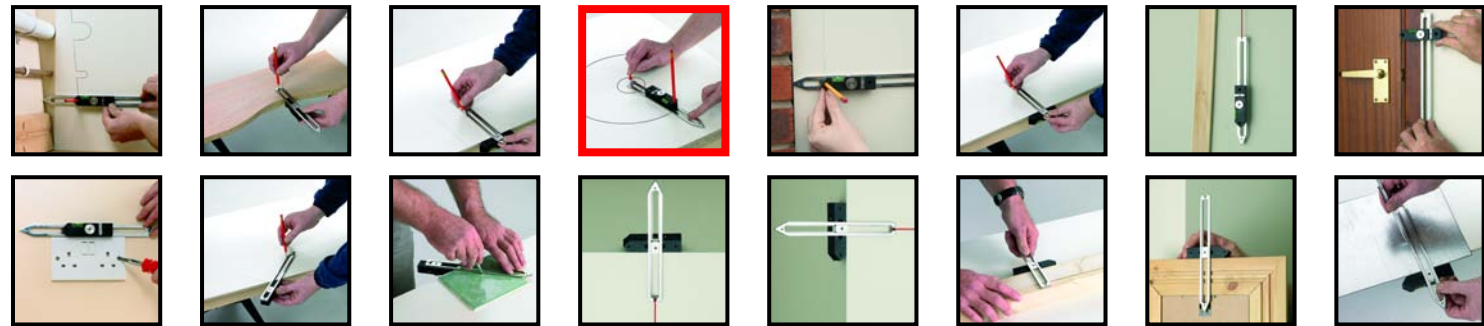
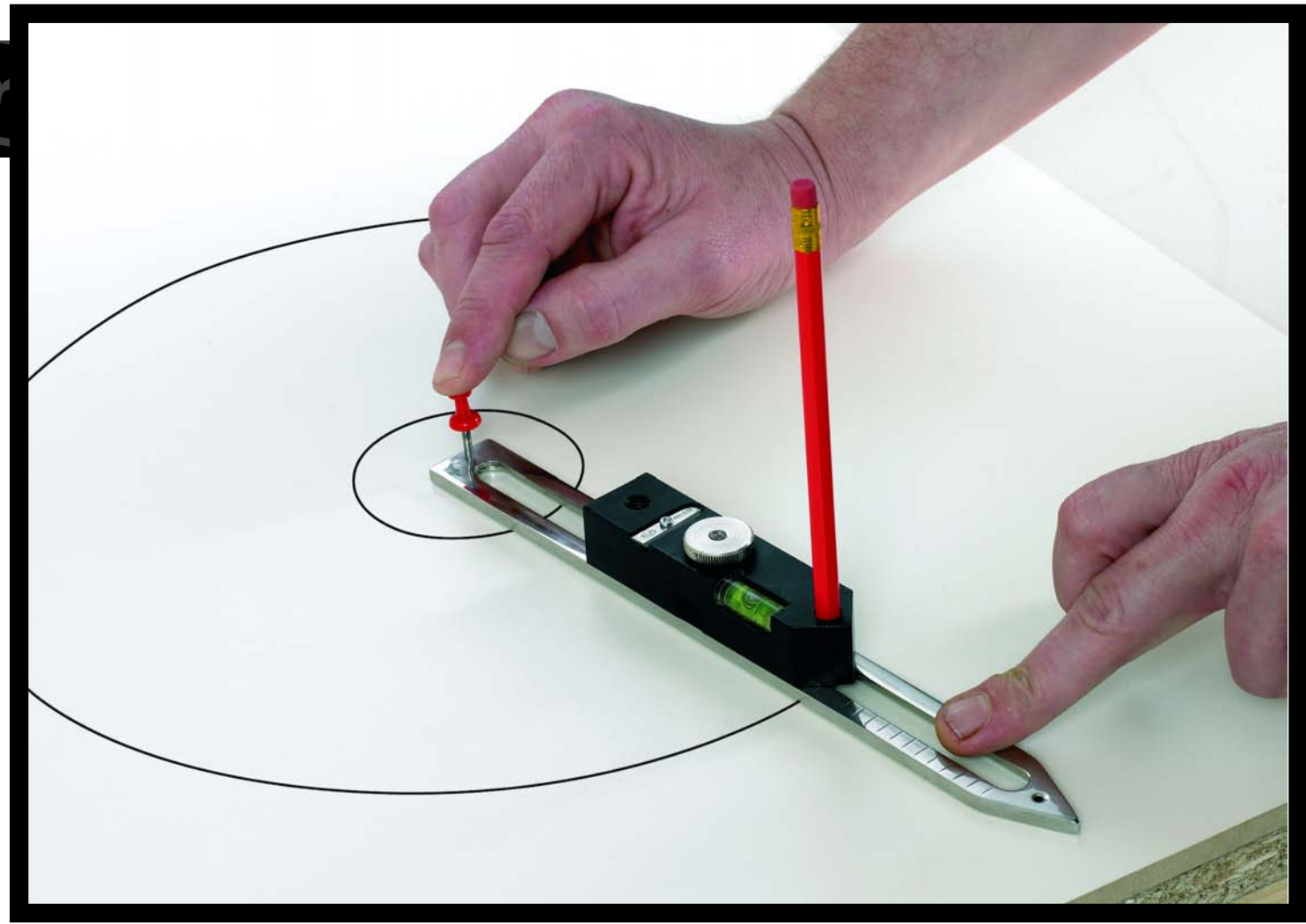

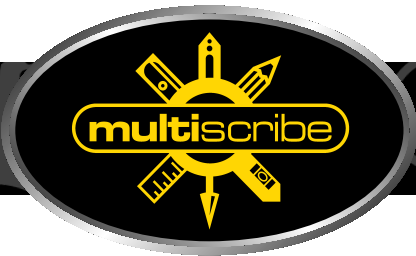

**THE TOOL FOR
ALL TRADES**

PROFILING SCRIBE

To copy and reproduce
exactly an uneven
surface.

[Click here to return to start](#)

(To exit press ESCAPE)

For more information on the
multiscribe please telephone:

BH  **Blundell Harling**
MANUFACTURING SOLUTIONS
01305 206 000

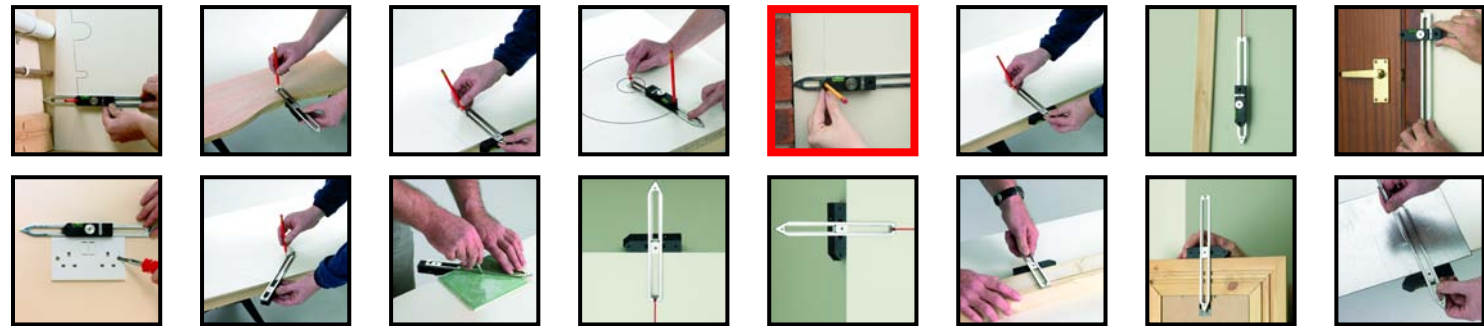

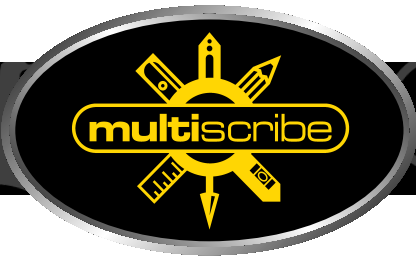

**THE TOOL FOR
ALL TRADES**

90° SQUARE

Marks a line at 90° to
a given straight or flat
surface

[Click here to return to start](#)

(To exit press ESCAPE)

For more information on the
multiscribe please telephone:

BH  **Blundell Harling**
MANUFACTURING SOLUTIONS
01305 206 000

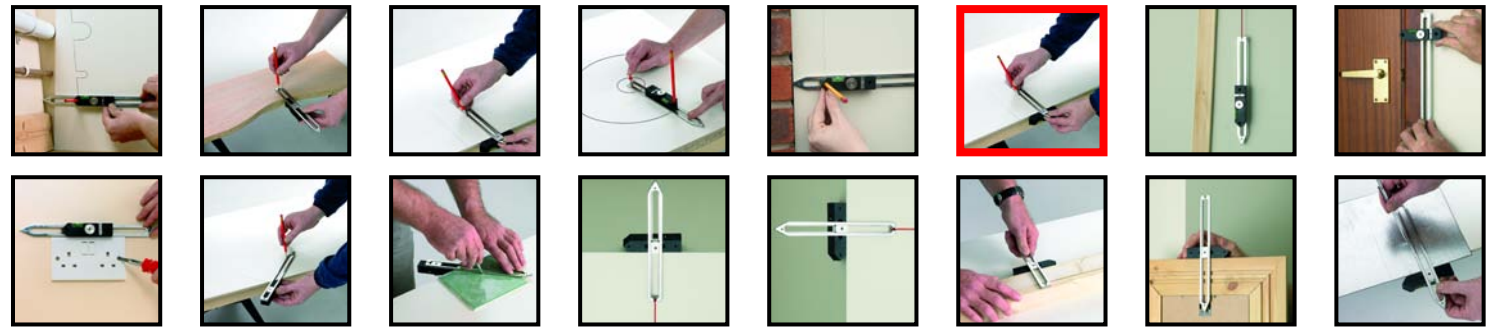
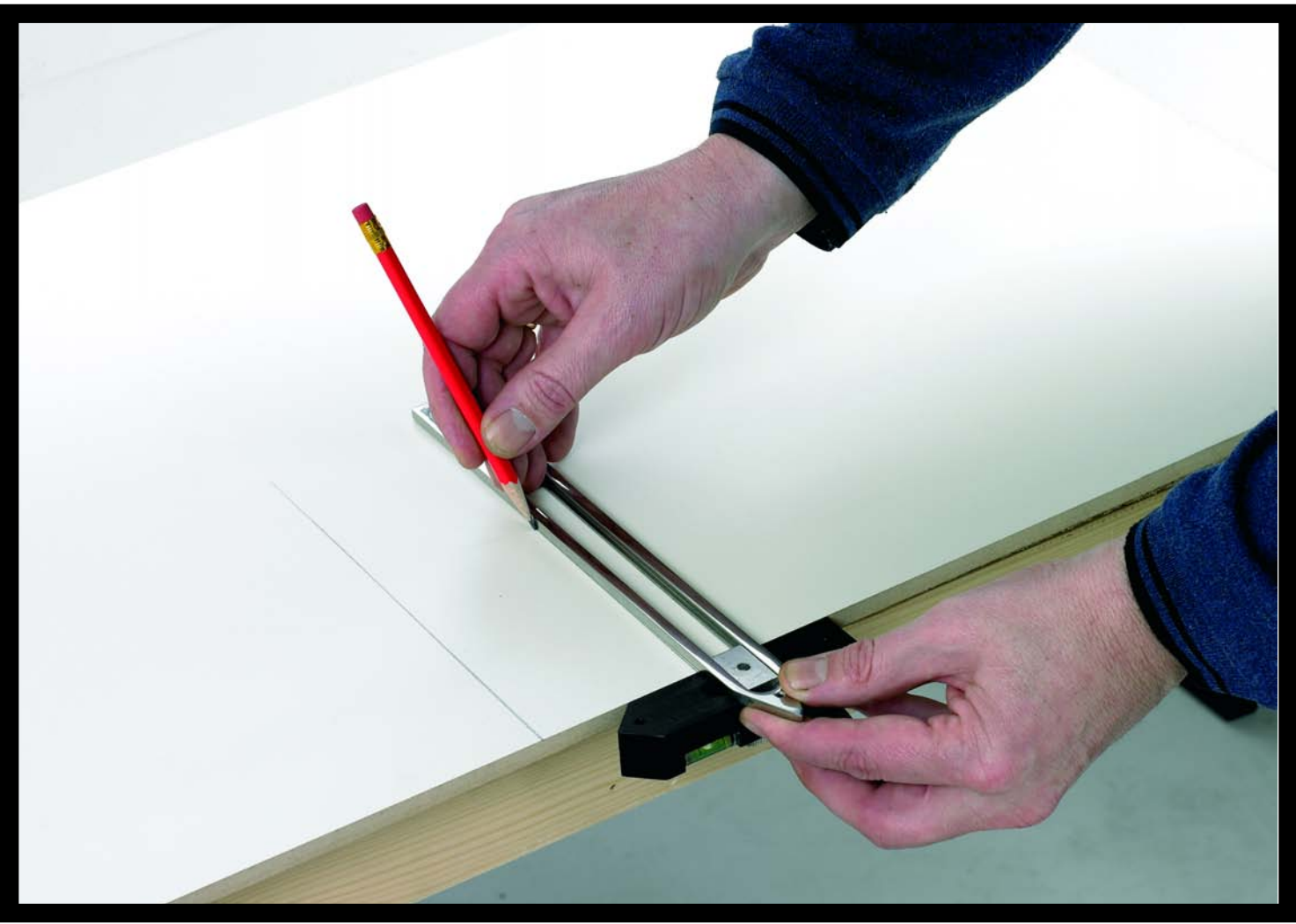

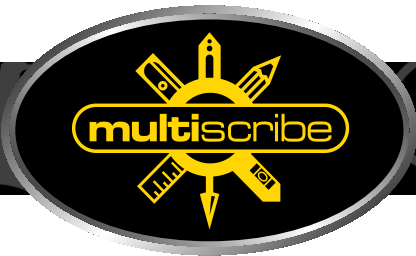

THE TOOL FOR ALL TRADES

PLUMB BOB

A string with a weight at one end to produce a vertical pointer

[Click here to return to start](#)

(To exit press ESCAPE)

For more information on the multiscribe please telephone:

BH  **Blundell Harling**
MANUFACTURING SOLUTIONS

01305 206 000

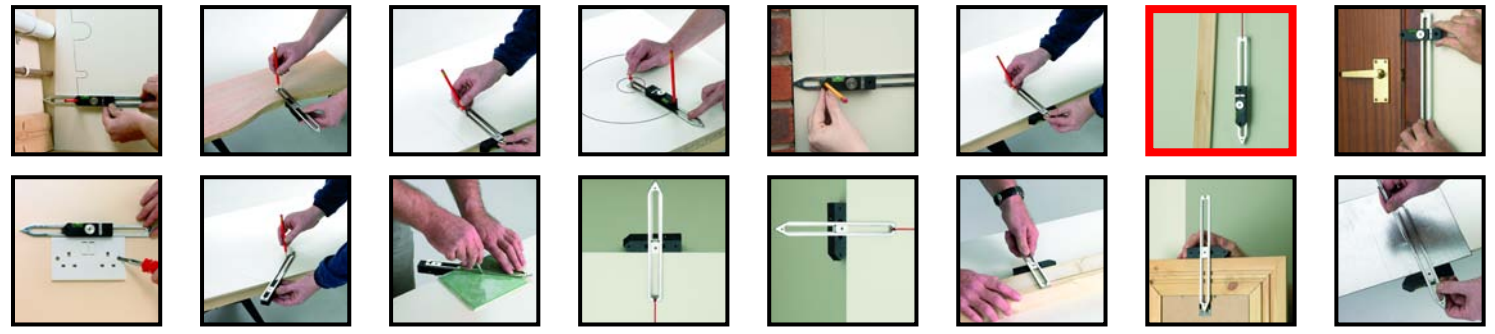

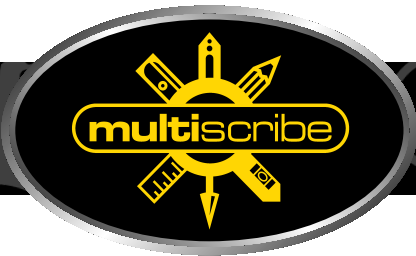

**THE TOOL FOR
ALL TRADES**

VERTICAL LEVEL

To give a true vertical

[Click here to return to start](#)

(To exit press ESCAPE)

For more information on the
multiscribe please telephone:



01305 206 000

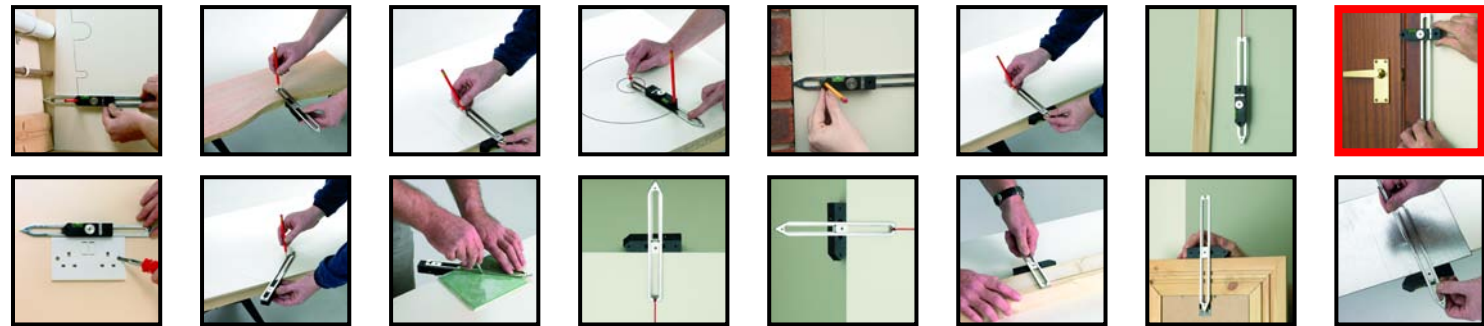

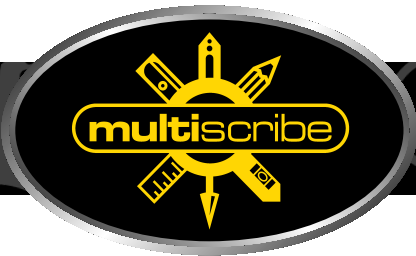

**THE TOOL FOR
ALL TRADES**

HORIZONTAL LEVEL

To give a true
horizontal line

[Click here to return to start](#)

(To exit press ESCAPE)

For more information on the
multiscribe please telephone:

BH  **Blundell Harling**
MANUFACTURING SOLUTIONS
01305 206 000

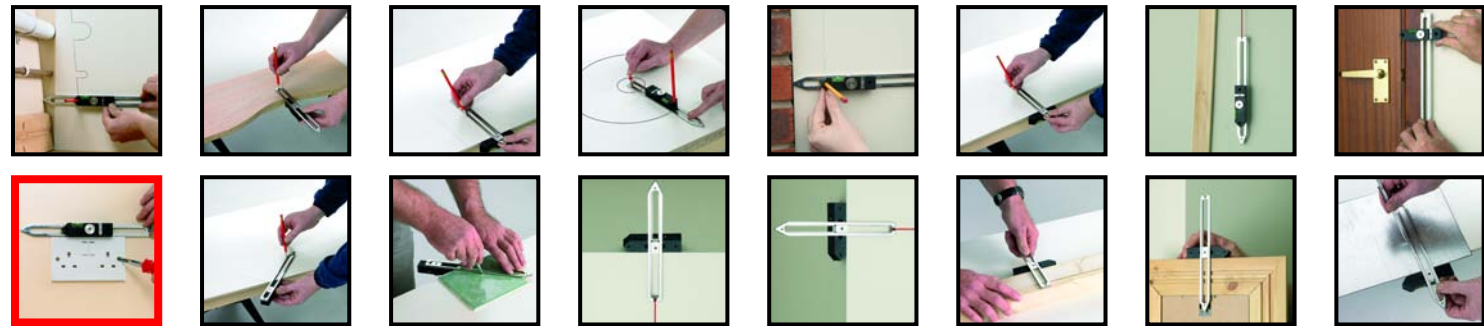
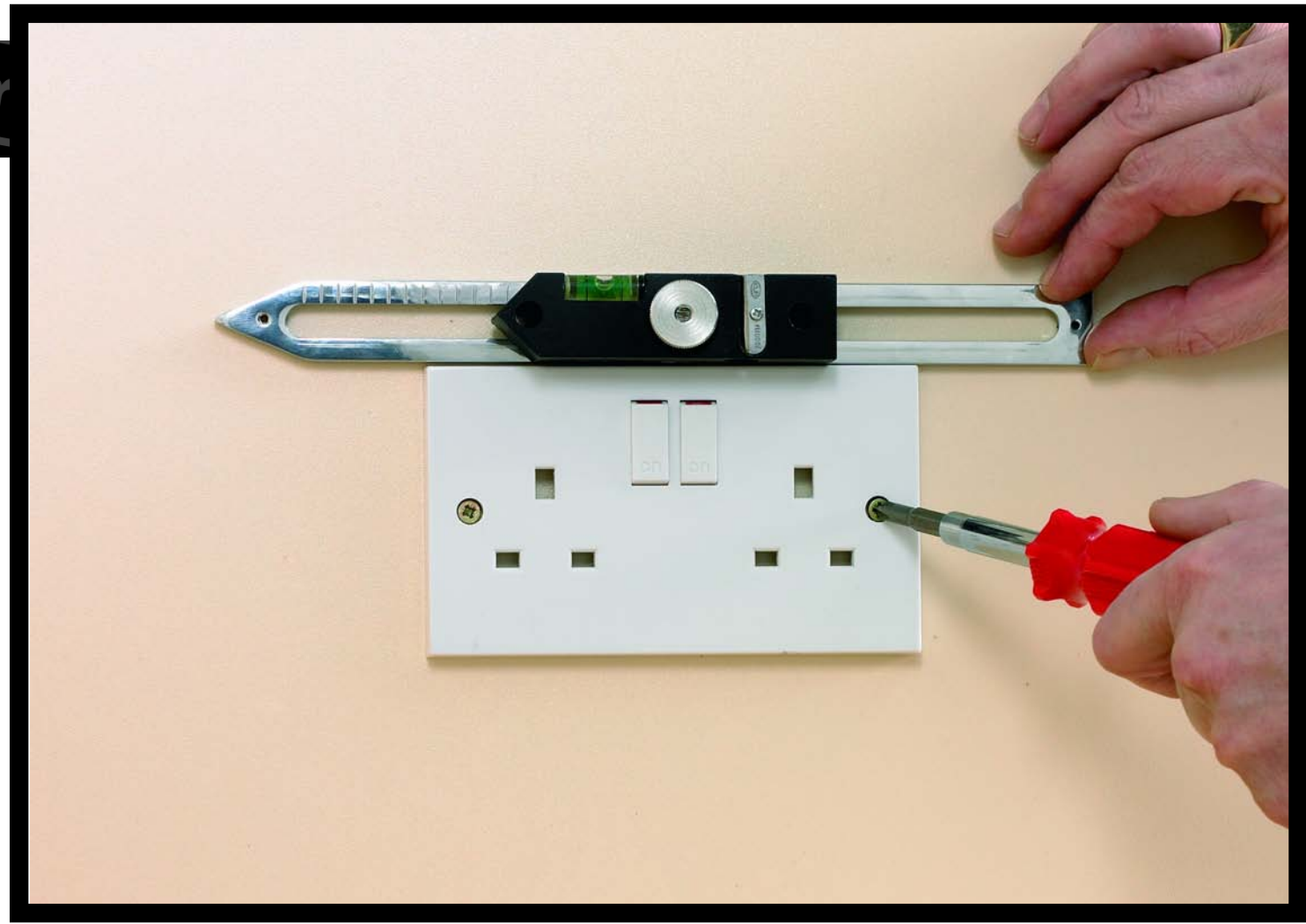

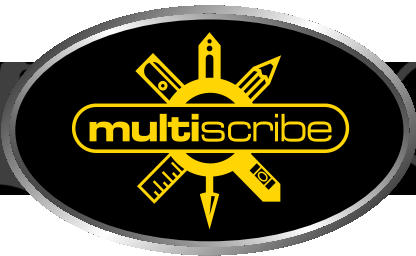

**THE TOOL FOR
ALL TRADES**

45° MITRE

Marks a line at 45°
to a given straight
or flat surface

[Click here to return to start](#)

(To exit press ESCAPE)

For more information on the
multiscribe please telephone:

BH  **Blundell Harling**
MANUFACTURING SOLUTIONS
01305 206 000

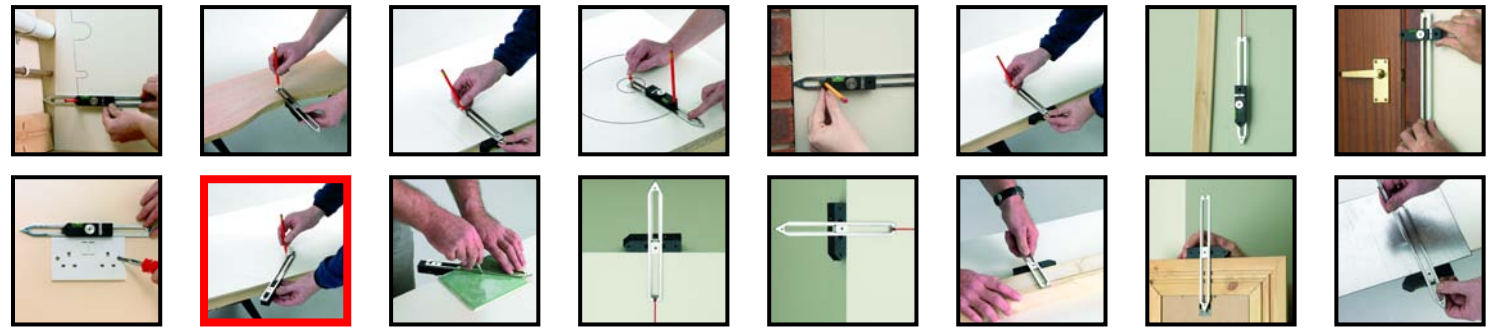
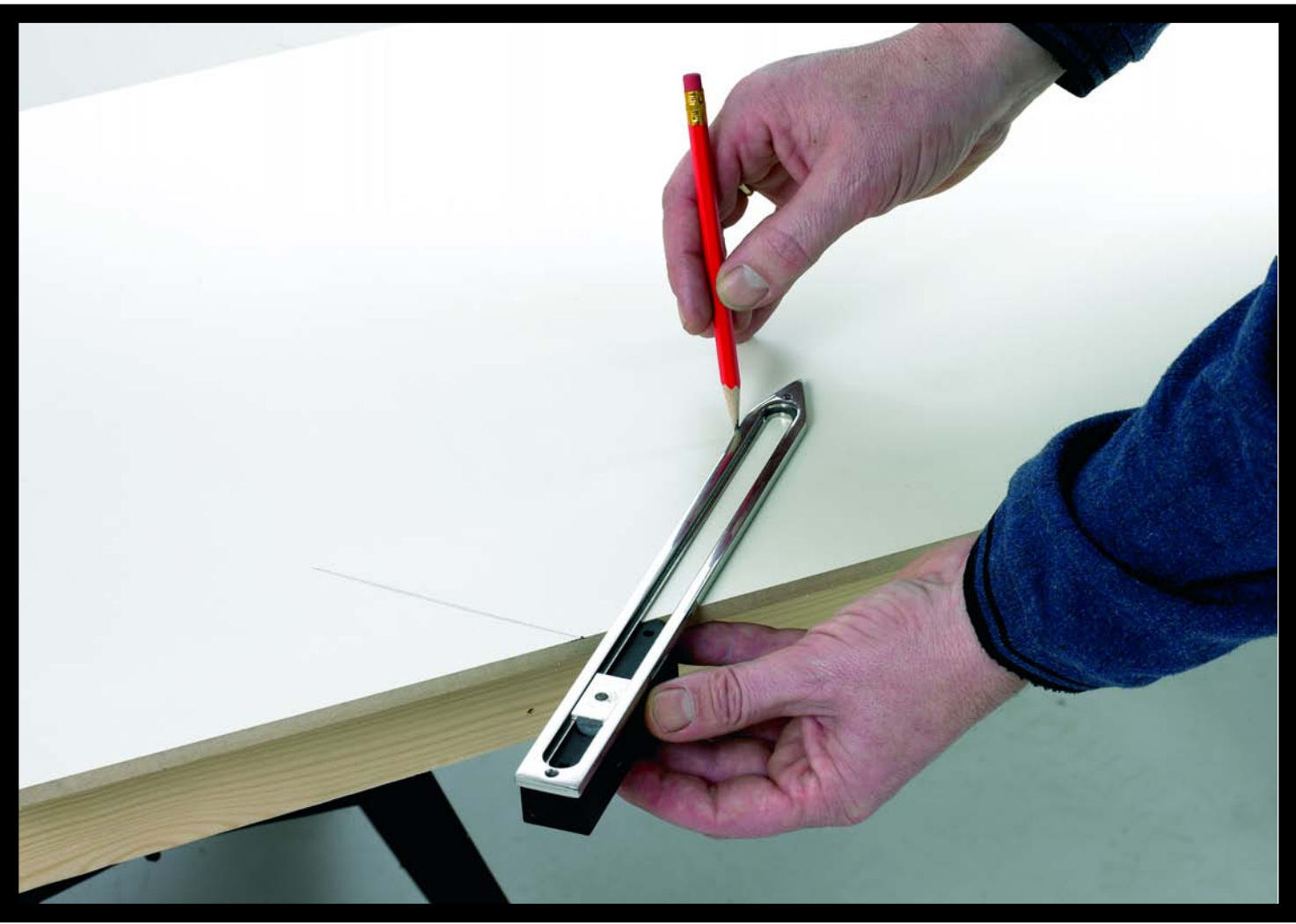

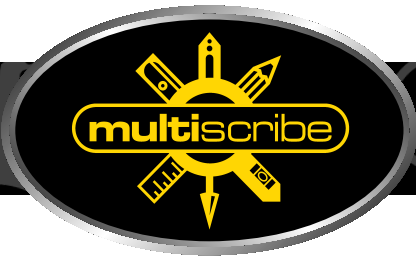

**THE TOOL FOR
ALL TRADES**

45° TILE SCORER

Marks a line at 45°
to enable accurate
tile cutting

[Click here to return to start](#)

(To exit press ESCAPE)

For more information on the
multiscribe please telephone:

BH  **Blundell Harling**
MANUFACTURING SOLUTIONS
01305 206 000

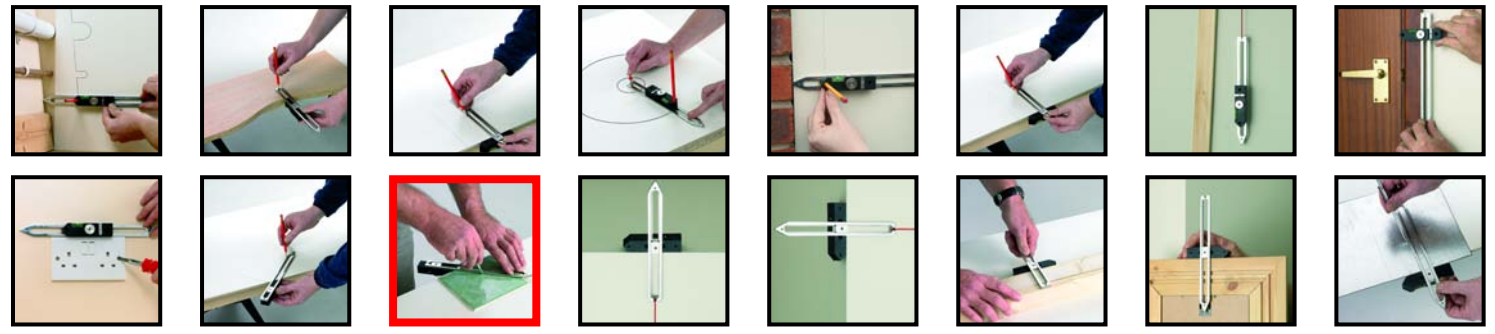

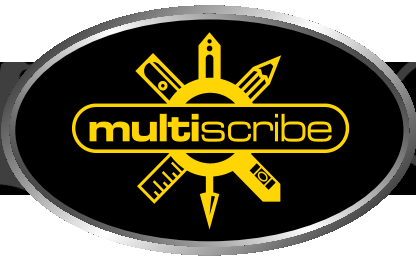

THE TOOL FOR ALL TRADES

STRING LINE

Gives a straight edge between two fixed points

[Click here to return to start](#)

(To exit press ESCAPE)

For more information on the multiscribe please telephone:

BH  **Blundell Harling**
MANUFACTURING SOLUTIONS

01305 206 000

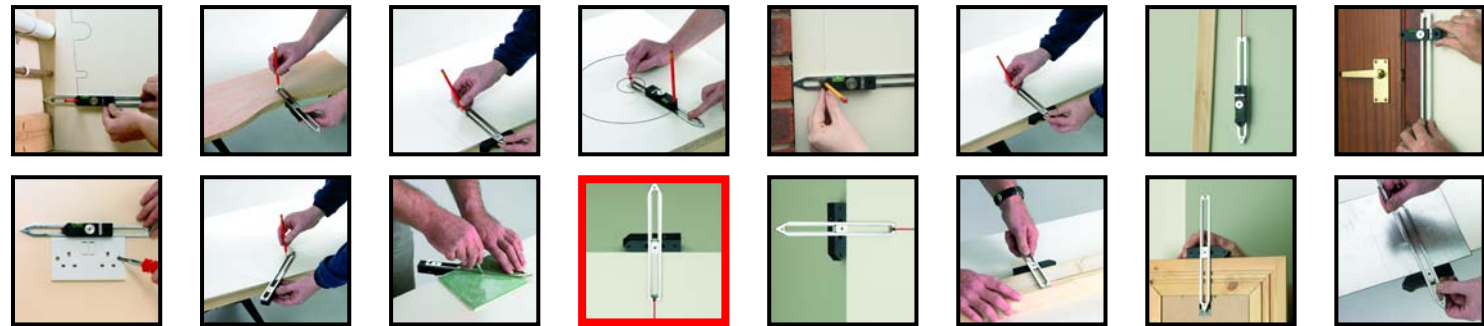
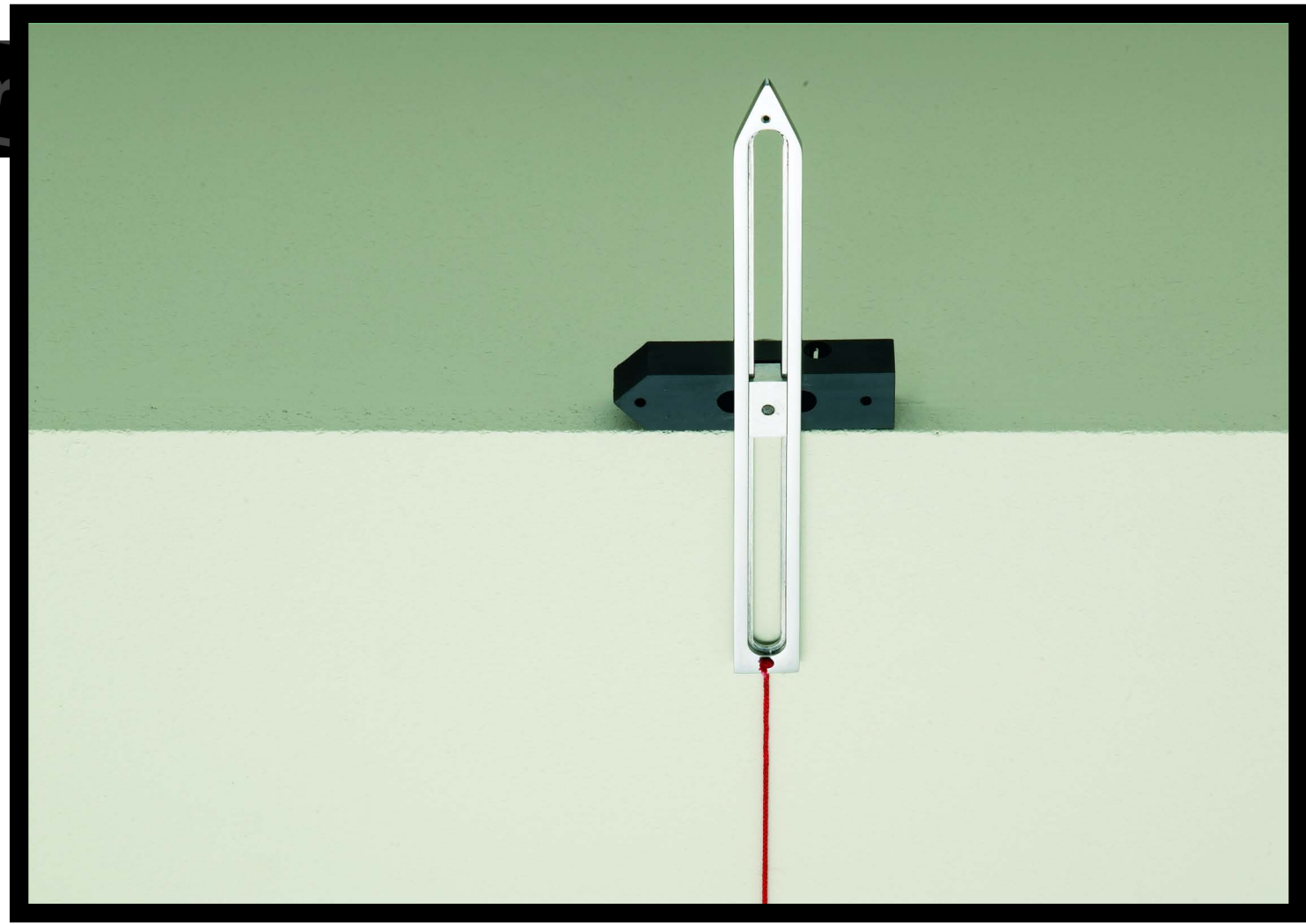

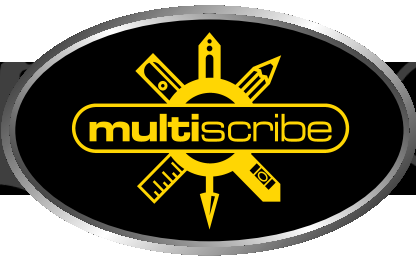

**THE TOOL FOR
ALL TRADES**

LINE BLOCK

A block that grips corners under the tension of a string line

[Click here to return to start](#)

(To exit press ESCAPE)

For more information on the multiscribe please telephone:



01305 206 000

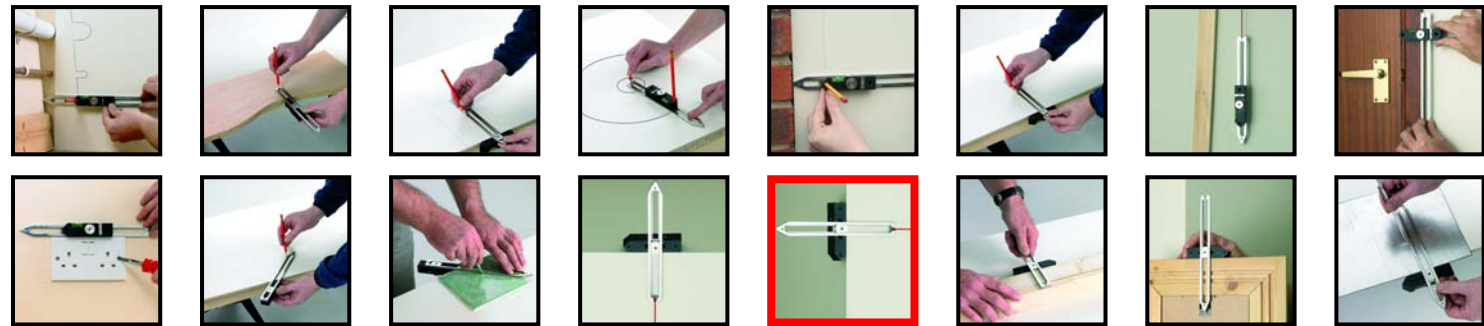
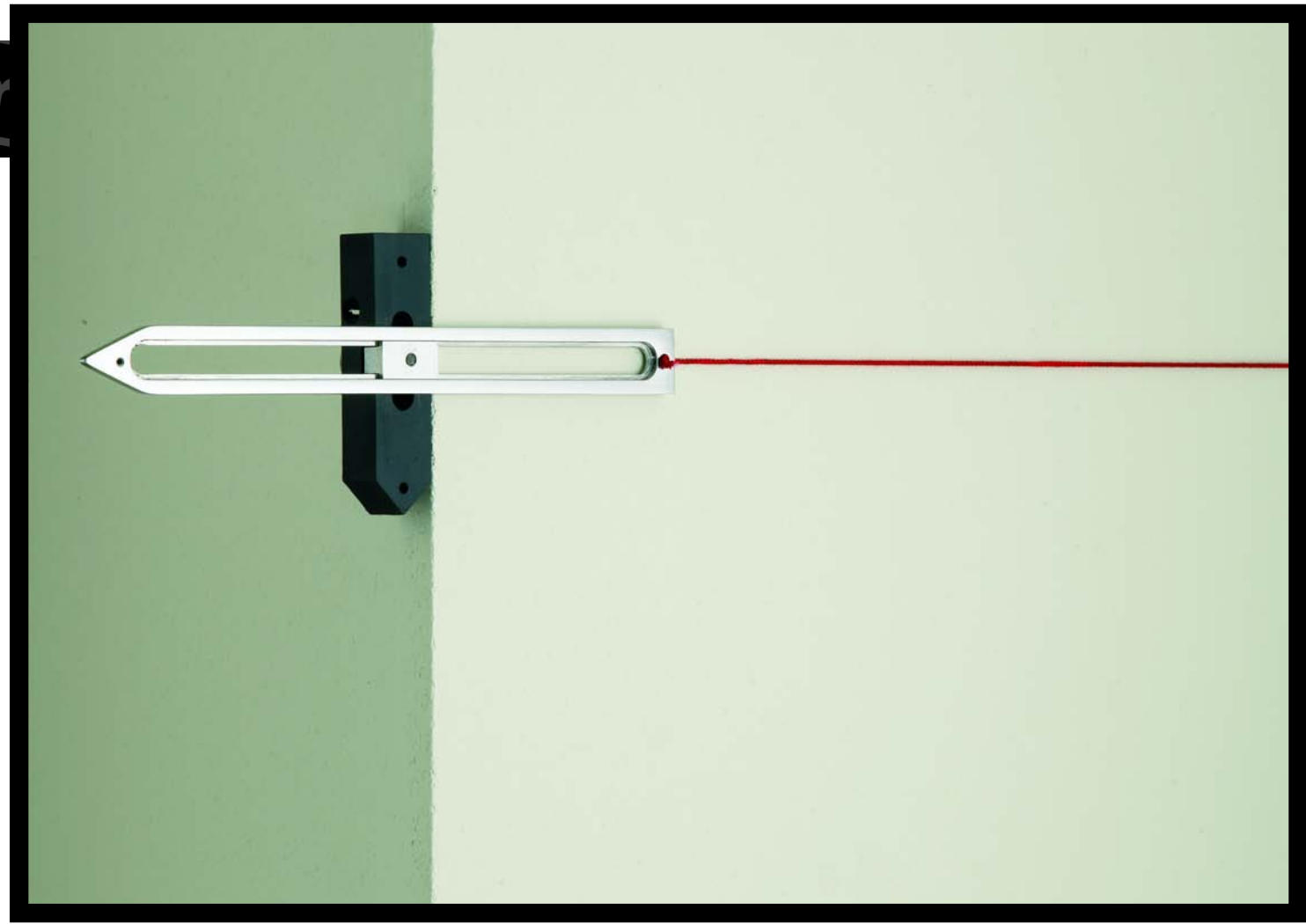

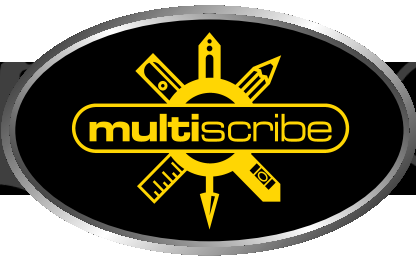

**THE TOOL FOR
ALL TRADES**

DEPTH GAUGE

To copy the width or
depth of an area for
transfer or marking

[Click here to return to start](#)

(To exit press ESCAPE)

For more information on the
multiscribe please telephone:



01305 206 000

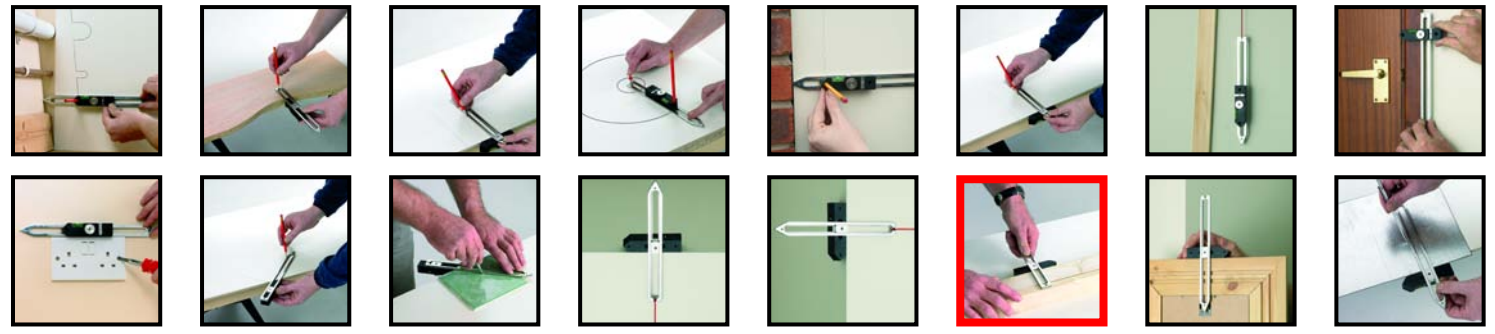

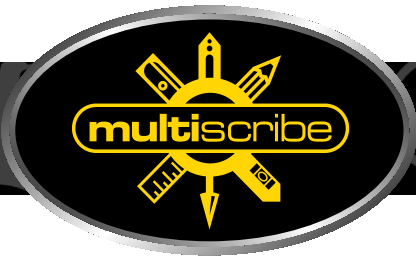

**THE TOOL FOR
ALL TRADES**

HANGING GAUGE

To measure and mark
the exact point on a
wall for level picture
hanging

[Click here to return to start](#)

(To exit press ESCAPE)

For more information on the
multiscribe please telephone:

BH  **Blundell Harling**
MANUFACTURING SOLUTIONS
01305 206 000

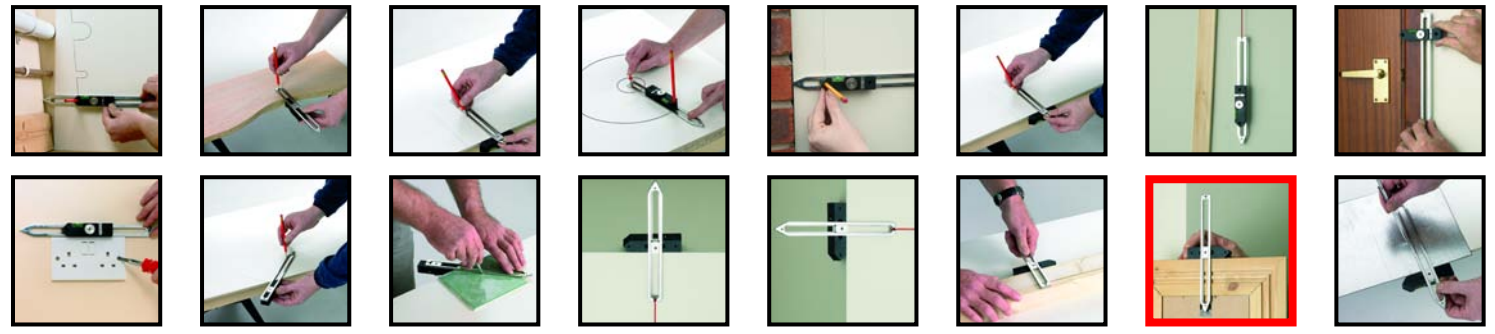
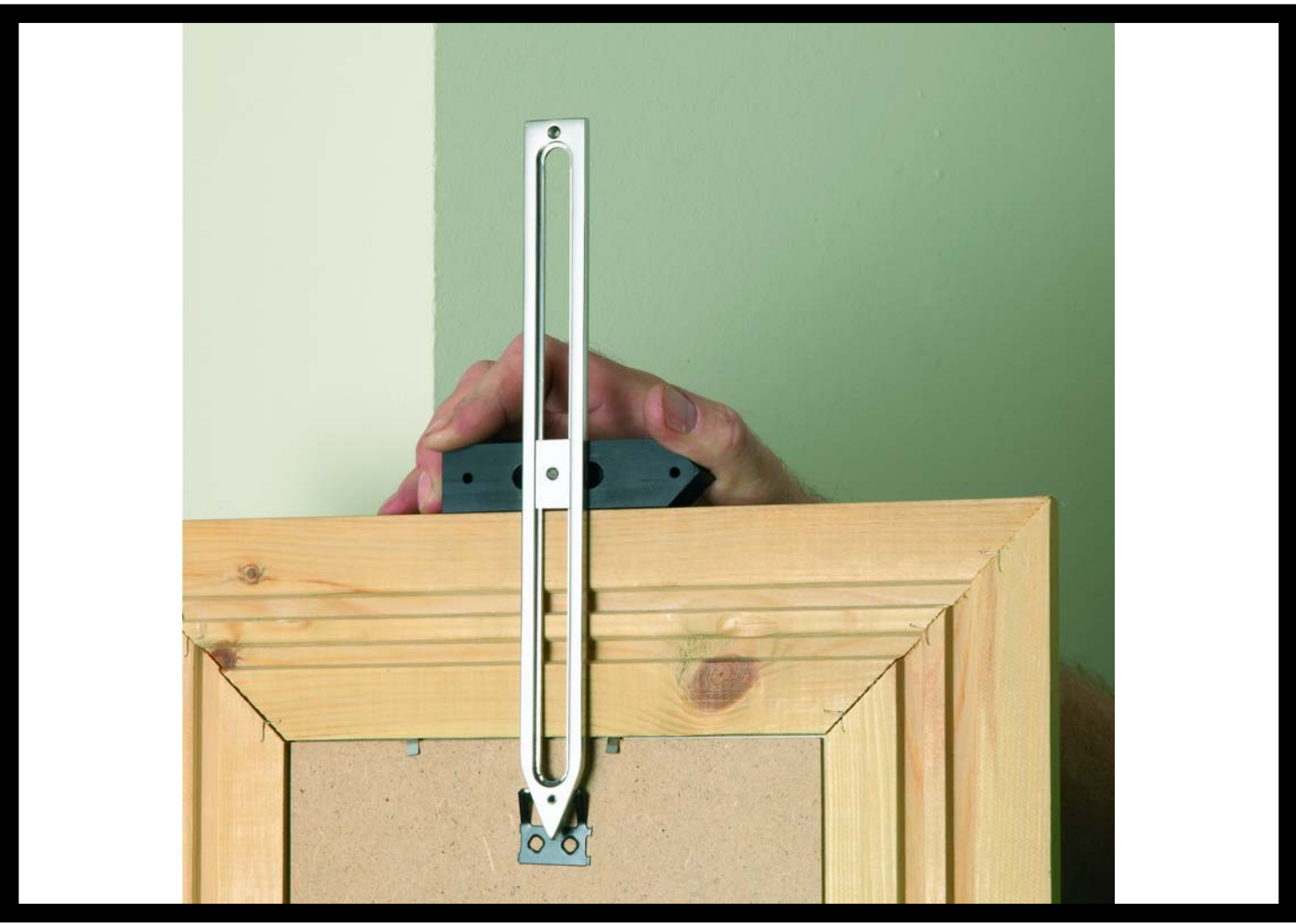

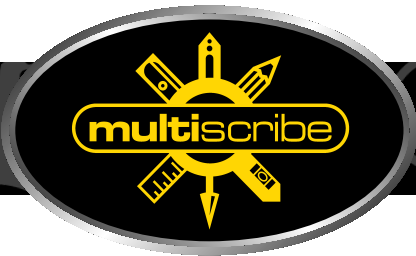

**THE TOOL FOR
ALL TRADES**

METAL SCRIBE

A metal pencil, with a tungsten tip, used in conjunction with the multiscribe for metalworking

[Click here to return to start](#)

(To exit press ESCAPE)

For more information on the multiscribe please telephone:



01305 206 000

